

## VIGAS DO MEZANINO

### VPM1-VPM10

ESC 1:50

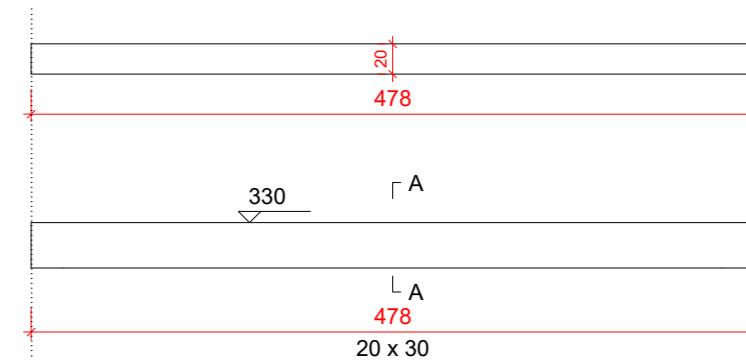

SEÇÃO A-A  
ESC 1:25

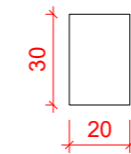

## VIGAS DE RESPALDO

### VPM1-VPM10

ESC 1:50

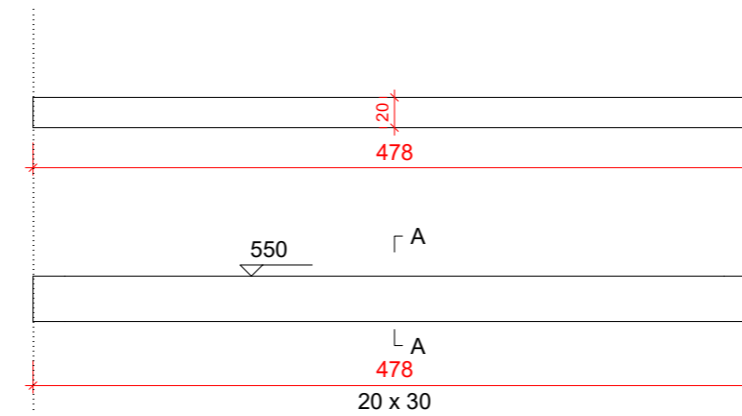

SEÇÃO A-A  
ESC 1:25

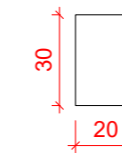

### VPM11-VPM22

ESC 1:50

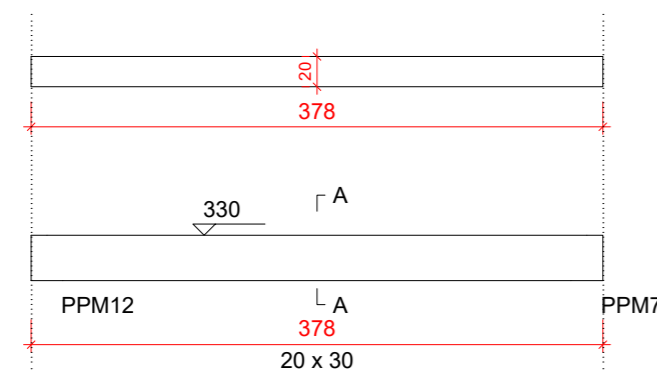

SEÇÃO A-A  
ESC 1:25

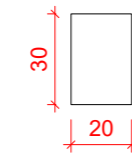

### VPM11-VPM18

ESC 1:50

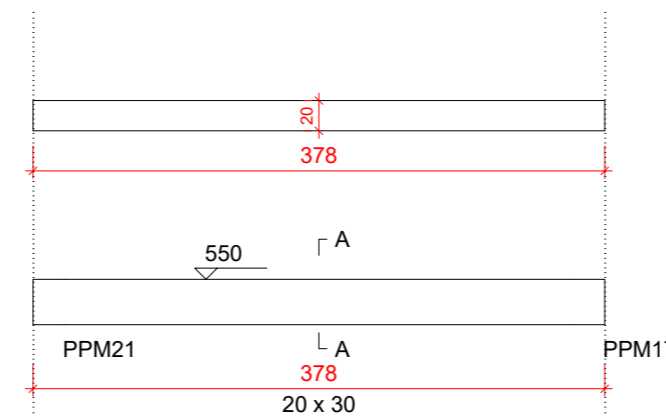

SEÇÃO A-A  
ESC 1:25

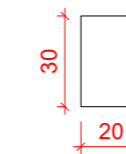

Aprovações:



Rua Roberto Trompowski, 68 - 2º andar / Tel: 49 3522-2800 - www.ammoc.org.br - e-mail: ammoc@ammoc.org.br - Joaçaba/SC

## PREFEITURA DE ERVAL VELHO

Obra:

### BARRACÃO PARA SECRETARIA DE AGRICULTURA

Local da Obra:

**RUA CEL. HONORATO VIEIRA - PROX. COHAB**

Conteúdo:

**GEOMETRIA DAS VIGAS PRÉ MOLDADAS**

Responsável Técnico:

Ana Júlia U. de Carvalho - Eng. Civil - Crea/SC 105.295-8  
 André Brito Dotti - Eng. Civil - Crea/SC 162.237-5  
 Denir Narcizo Zulian - Eng. Civil - Crea/SC 50.805-8  
 Fábio Zilio Caron - Eng. Civil - Crea/SC 140.642-7  
 Lucas F. Balestrin - Eng. Agrônomo - Crea/SC 156.743-7  
 Max Mooshammer - Eng. Civil - Crea/SC 139.164-0  
 Suellen Karine Cervelin - Eng. Civil - Crea/SC 166.933-0

**EST  
08/11**

Quaisquer alterações consulte os responsáveis técnicos:

Assinatura Responsável Técnico

Assinatura Prefeito(a) Municipal

Desenho:

Fábio Z. Caron

Data:

Agosto / 2022

Escala:

Indicada (s)

Área Total:

404,11 m<sup>2</sup>

**ESTRUTURAL**