

APOIO DA GRADE  
Escala: 1/15

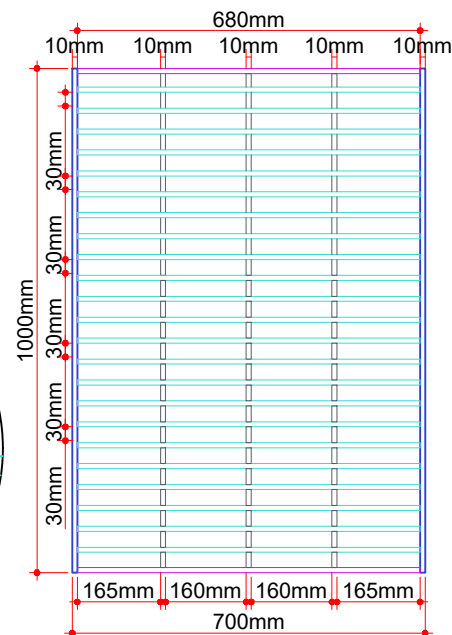

GRADE DE FERRO  
Escala: 1/15

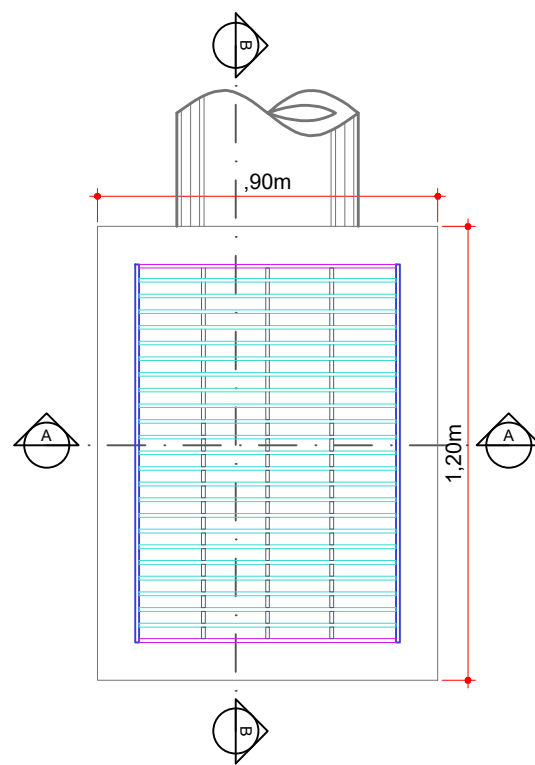
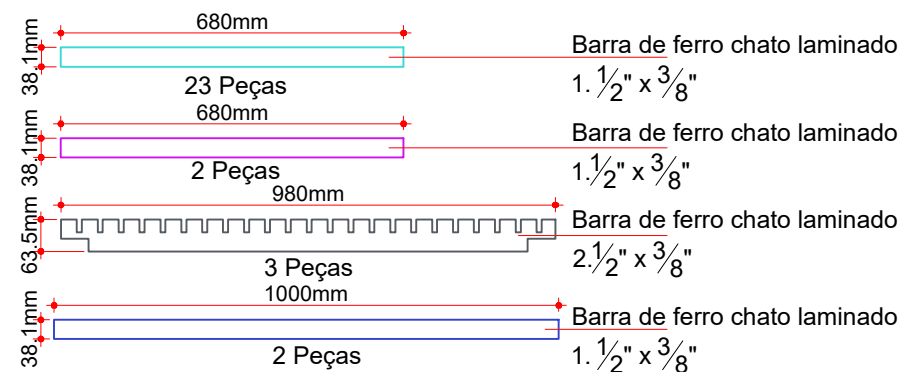
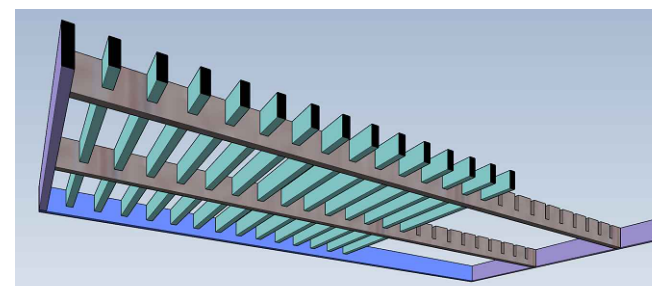

PLANTA BAIXA  
Escala: 1/20

BOCA DE LOBO - TIPO I - Ø300mm/Ø400mm

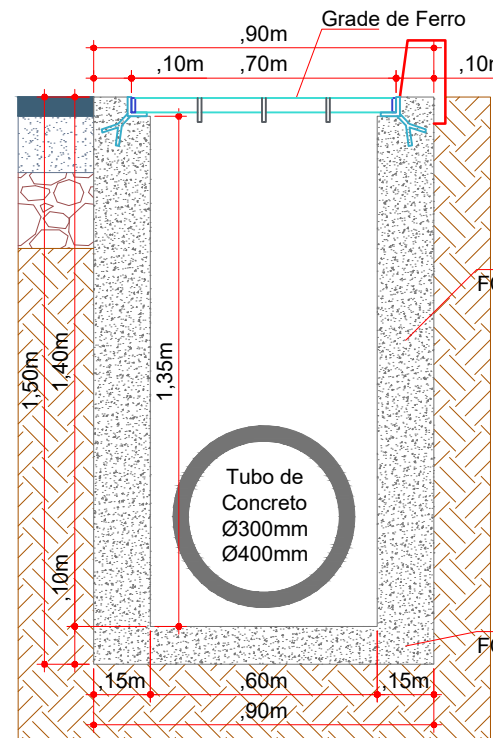

CORTE AA  
Escala: 1/20

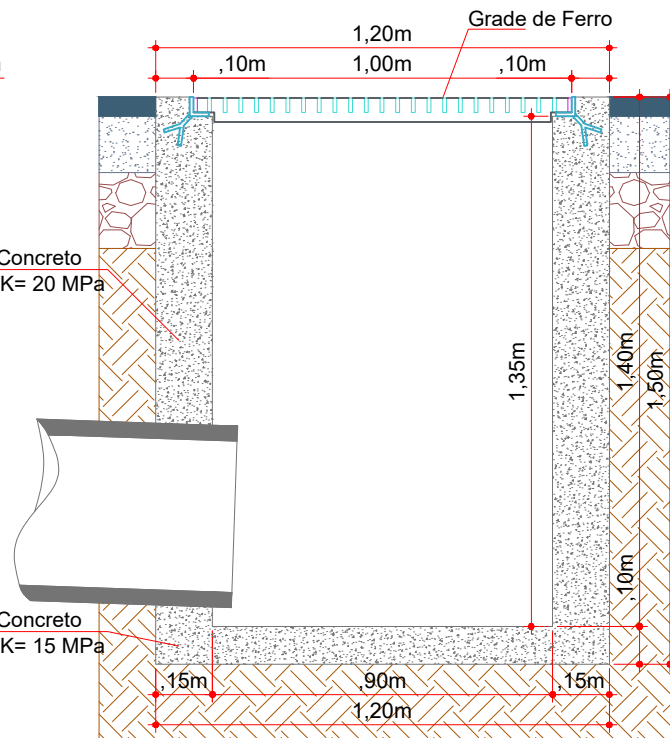

CORTE BB  
Escala: 1/20

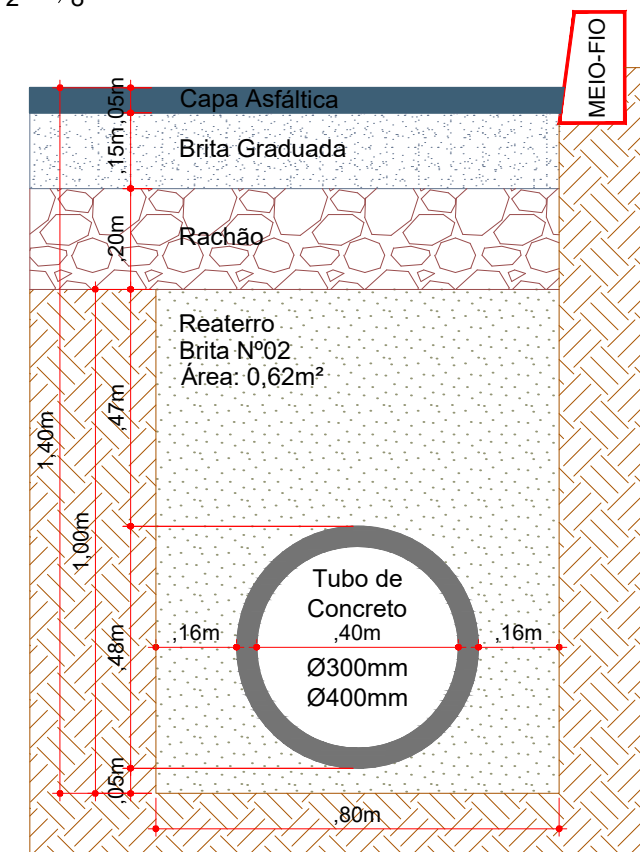

REATERRO DE VALA (Ø300/400mm)  
Escala: 1/15



Projeto: Pavimentação em Asfalto C.A.U.Q. da Rua das Ameixeiras

Responsável Técnico:  
Ana Júlia U. de Carvalho - Eng. Civil - CREA-SC 105.295-8  
Andre Brito Dotti - Eng. Civil - CREA-SC 162.237-5  
Denir Narcizo Zulian - Eng. Civil - CREA-SC 50.805-8  
Fábio Zilio Caron - Eng. Civil - CREA-SC 140.642-7  
Felipe L. Parisoto - Eng. Agrônomo - CREA-SC 183.059-9  
Lucas F. Balestrin - Eng. Agrônomo - CREA-SC 156.743-7  
Max Mooshammer - Eng. Civil - CREA-SC 139.164-0  
Suellen Karine Cervelin - Eng. Civil - CREA-SC 166.933-0

Drenagem

DRE.  
03/04

Assinatura Prefeito(a) Municipal Assinatura Responsável Técnico

Desenho: André Felipe Kasteller Data: abril de 2023 Revisão: - Escala: indicada (s) Trecho: 0+0,000 - 10+13,286